



COST LESS LIGHTING

11-6C-LED-NND

6" IC LED Dedicated Cans

APPLICATIONS

Designed for new construction installations and suitable for use in ceilings with direct contact with insulation. Air tight construction provides reduced energy costs.

FEATURES

- Galvanized steel construction with removeable housing for easy access to the junction box
- Listed for through branch circuit wiring
- Pre-installed Real nail easily installs in regular and engineered lumber
- Adjustable bar hangers from 13⁵/₈" - 25" and can be repositioned 90° on plaster frame
- Contains one 1¹/₈", six 7⁸/₈" knockouts and four Romex pryouts with strain relief

APPLICATIONS

Designed for remodel installations and suitable for use in ceilings with direct contact with insulation. Air tight construction provides reduced energy costs.

FEATURES

- Galvanized steel construction with removeable housing for easy access to the junction box
- Listed for through branch circuit wiring
- Four remodel clips secure housing and accommodates 1/2" and 5/8" ceiling materials
- Housing adjusts from 5/8" - 1 3/8" to accommodate various ceiling thicknesses
- Contains one 1¹/₈", six 7⁸/₈" knockouts and four Romex pryouts with strain relief

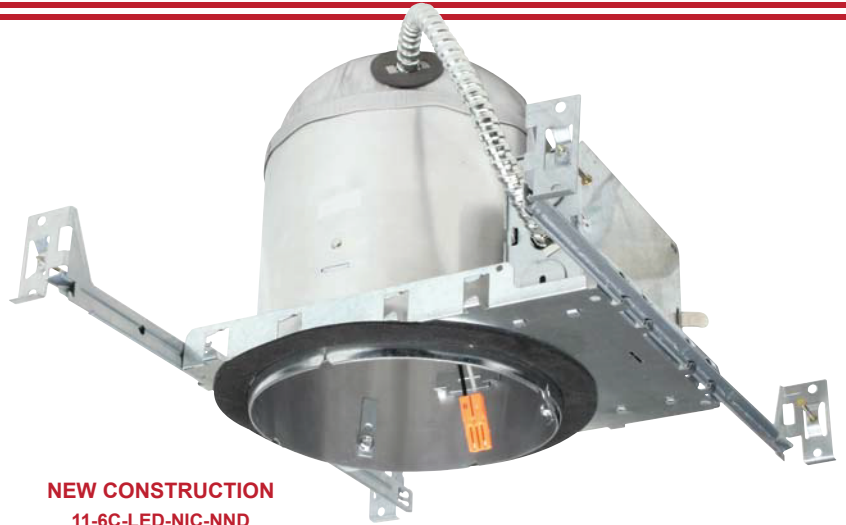

NEW CONSTRUCTION
11-6C-LED-NIC-NND

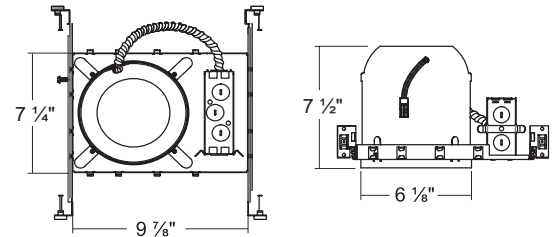

REMODEL
11-6C-LED-RIC-NND

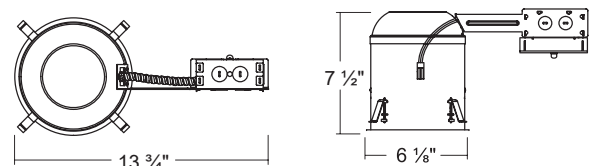

MODEL	DESCRIPTION
11-6C-LED-NIC-NND	6: LED IC NW at Can; No Driver
11-6C-LED-RIC-NND	6: LED IC REM at Can; No Driver

PROJECT	TYPE	CATALOG #