



PROJECT	TYPE	CATALOG #



MODEL	DESCRIPTION
25-DWOS-3J	Occupancy/Vacancy Sensor Wall Switch, PIR, 3-Way, Decorator, 120V or 277V, 800W Max, White

Features

- Automatically On/Off, manual On/automatically Off
- Self adaptive feature automatically adjusts time delay based on occupants behavior patterns
- No neutral required which can be installed in both old and new houses
- Latching relay allows sensor to work at low power
- Compatible with all kinds of load including electronic ballast
- Adjustable sensitivity settings

Description

- The passive infrared sensors work by detecting the difference between heat emitted from the human body in motion and the background space. The sensor switch can turn a load on and hold it as long as the sensor detects occupancy. After no motion is detected for the set time delay, the load turned off automatically. The sensor switch has one relay (equal to single pole switch), also includes Ambient Light Level Sensor

Specifications

Specifications

- Voltage: 120/277VAC, 60Hz
- Incandescent: 800W
- Fluorescent/Ballast: 800VA@120VAC/1600VA@277VAC
- Motor: 1/4HP
- Time Delay: 15Sec to 30Mins
- Light Level: 30 Lux - Daylight
- Operation Temperature: 32°F - 131°F (0°C - 55°C)

Coverage Pattern

The coverage range of the sensor switch is specified and illustrated in figure below. Large objects and some transparent barriers like glass windows will obstruct the sensors' view and prevent detection, causing the light to turn off even though someone is still in the detection area.

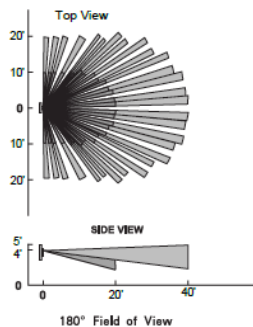

Operation

The Sensor Switch is programmed independently for either Occupancy Mode or Vacancy Mode as refer to the Band Switch position under the control panel cover. Some might call the Vacancy mode as "Manual On Occupancy Mode"

Manual On/Off Button

- By Pushing the Control Panel Cover, the Load can be turned On/Off under either OCC or VAC mode

Turning On the Load under Occupancy Mode

- Load to be Automatic On once occupancy detected

Turning On the Load under Vacancy Mode

- Manual On/Off button has to be pushed to turn on the load

Automatic Turning Off the Load

- Under either mode, the sensor keeps the load On until no motion is detected plus the set time delay, load(s) to be Off automatically. Under VAC mode, the load can turn On automatically if motion is detected within the first 30 seconds

Manual Turning Off the Load

- By Manual On/Off button, the load can be turned Off under either OCC or VAC mode. Under OCC Mode, if you press manual On/Off button first and no motion is detected, the sensor switch returns to normal after 5 minutes.

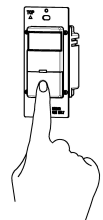

Warranty

If within two (2) years from the date of purchase, this product fails due to a defect in material or workmanship, we will repair or exchange it, at its sole option free of charge. This warranty does not apply to (a) damage to units caused by accident, dropping or abuse in handling, acts of God or any negligent use; (b) units which have been subject to un-authorized repair, opened, taken apart or otherwise modified; (c) unit not used in accordance with instruction; (d) damages exceeding the cost of the product; (e) finish on any portion of the product, such as surface and weathering, as this is considered normal wear and tear; (f) transit damage, initial installation costs, removal costs, or reinstallation costs.

This warranty service is available by returning the product with proof of purchase, purchase date and a description of the problem to the dealer from whom the unit was purchased.



Adjustment

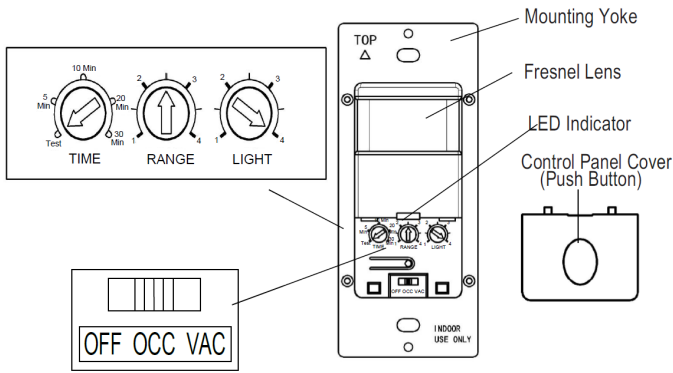

Band Switch Prescription

Mode	Position	Description	React to the push-button
OFF	Left	Circuit is permanently opened. (switched off)	None
OCC	Center	Occupancy Mode: Automatic On, automatic Off after set time delay	Manually toggles On/Off the load
VAC	Right	Vacancy Mode: Manual On only, automatic Off after set time delay	Manually toggles On/Off the load

Time Delay Knob

Default position: 15 seconds (Test mode)

Adjustable: from 15 seconds to 30 minutes (clockwise)

Sensor Sensitivity Range Knob

Default Position: Center at 65%

Adjustable: 30% (Position 1) to 100% (Position 4)

NOTE: Turn toward right for greater room space. Turn toward left to avoid false alert in smaller room and near the door way or heat source

Ambient Light Level Knob

Default Position: Daylight (100% at Position 4)

Adjustable: Daylight to 30Lux (Counter clockwise)

NOTE: To avoid wasting energy by turn-on the light under daylight.